



Brand New Home, Warfield, Bracknell, Berkshire

£520,000

🛏️ 2 🚿 2 🛋️ 2



- Brand New Park Home Bungalow
- Spacious and Light Accommodation
- Lissett Echappe 45'x22' Design
- Two Double Bedrooms
- Generous Enclosed Plot
- Feature Integrated Kitchen
- Garage and Driveway
- Ensuite and Guest Bathroom
- Sought After Residential Park
- Ready To View and Purchase NOW!



A brand new luxurious park home bungalow located on a generous plot on this sought after Residential Park close to Bracknell. This 'Lissett' built home (45'x22') boasts light and spacious accommodation including an impressive, modern kitchen with vaulted ceiling, a spacious lounge, a dining area off the kitchen, two double bedrooms with the master having an ensuite and a walk-in wardrobe area and a further guest bathroom. The home is situated on a generous, enclosed plot with gardens to all sides of the home as well as a detached garage and driveway.



The Elms, Warfield Park, Bracknell, RG42

Approximate Area = 963 sq ft / 89.4 sq m
 Garage = 187 sq ft / 17.3 sq m
 Total = 1150 sq ft / 106.7 sq m

For identification only - Not to scale

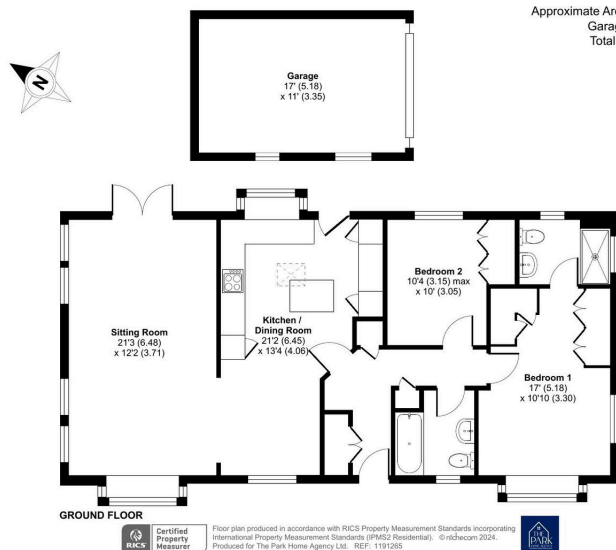

01793 230185
 sales@theparkhomeagency.co.uk

Agents Notes: All measurements are approximate and quoted in metric with imperial equivalents and for general guidance only and whilst every attempt has been made to ensure accuracy, they must not be relied on. The fixtures, fittings and appliances referred to have not been tested and therefore no guarantee can be given that they are in working order. Internal photographs are reproduced for general information and it must not be inferred that any item shown is included with the property. For a free valuation, contact the numbers listed on the brochure